

Custom Home Site in Town

South East St., Warrenton 63383

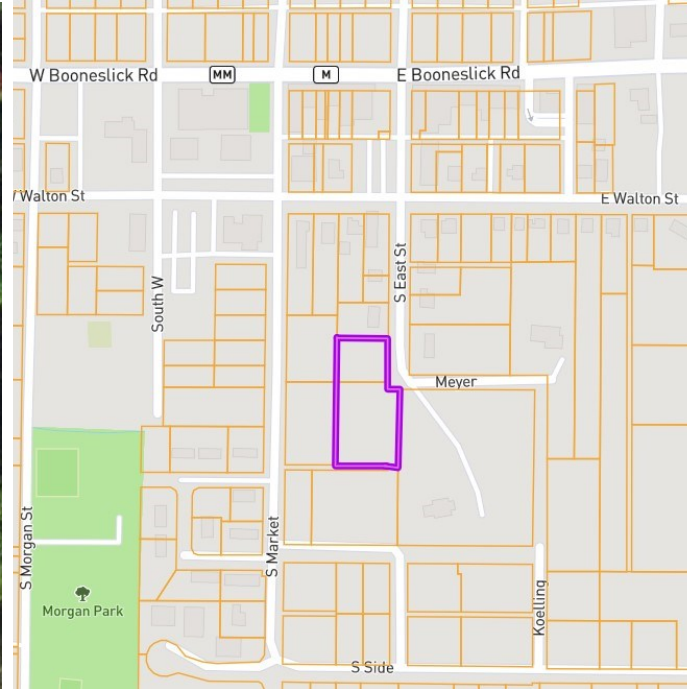

1.25+/- acres ♦ \$38,000

- ♦ Great custom home site
- ♦ Large wooded lot
- ♦ Located in the center of town
- ♦ Level to gently sloping
- ♦ Flat creek bottom
- ♦ Warrenton R-III School District



Phil Reid

Cell: (314) 486-8642

Office: (636)456-5922

Phil@LandToday.com

Westbound Real Estate



21 NStringtown Rd.
Forstell, MD 63348

www.LandToday.com

Directions: From 70 - South on 47 to West on E. Main (E.Booneslick) to South on S. East Street. Property starts after last house on the Right. Watch for the Westbound Real Estate sign.